

PERSLUCHTLEIDINGEN
CONDUITES D'AIR COMPRIMÉ
COMPRESSED AIR PIPING SYSTEMS





buizen
tuyaux
pipes

VINKAIR

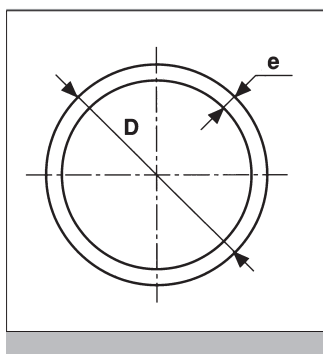

VINKAIR BUIZEN
TUYAUX VINKAIR
VINKAIR PIPES

LICHTBLAUW NF A 571
BLEU CLAIR NF A 571
LIGHT BLUE NF A 571

L = 4m

gladde uiteinden
bouts lisse
butt ends

| | Dxs | DN | PN | KG/M | €/M |
|-------------------|------------|-----------|-----------|-------------|---------------|
| 16 x 1,8 | | 10 | 12.5 | 0.106 | 6.09 |
| 20 x 2,3 | | 15 | 12.5 | 0.168 | 7.71 |
| 25 x 2,8 | | 20 | 12.5 | 0.257 | 10.94 |
| 32 x 2,9 | | 25 | 12.5 | 0.340 | 16.55 |
| 40 x 3,7 | | 32 | 12.5 | 0.542 | 31.61 |
| 50 x 4,6 | | 40 | 12.5 | 0,842 | 37.23 |
| 63 x 5,8 | | 50 | 12.5 | 1.334 | 48.66 |
| 75 x 6,8 | | 65 | 12.5 | 2.090 | 72.16 |
| 90 x 8,2 | | 80 | 12.5 | 3.030 | 101.92 |
| 110 x 10,0 | | 100 | 12.5 | 4.480 | 144.74 |

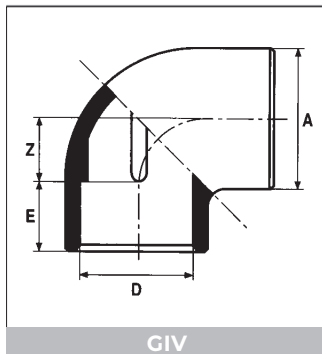

GIV

KNIEEN 90°
 COUDES A 90°
 ELBOWS 90°

PN 12.5

Beide zijden lijmmof / Deux côtés femelles à coller / Sockets for solvent welding

| D | DN | Z | E | A | €/ST/PC |
|-----|-----|------|------|-------|---------|
| 16 | 10 | 10.0 | 9.0 | 21.0 | 2.69 |
| 20 | 15 | 11.0 | 17.0 | 28.5 | 2.93 |
| 25 | 20 | 14.0 | 19.9 | 35.8 | 3.90 |
| 32 | 25 | 17.0 | 23.0 | 44.0 | 4.26 |
| 40 | 32 | 23.0 | 27.0 | 49.0 | 9.91 |
| 50 | 40 | 27.0 | 31.5 | 58.0 | 12.69 |
| 63 | 50 | 33.0 | 38.0 | 73.0 | 19.74 |
| 75 | 65 | 39.0 | 44.0 | 92.5 | 41.92 |
| 90 | 80 | 49.0 | 52.5 | 112.0 | 57.43 |
| 110 | 100 | 58.0 | 62.0 | 131.5 | 86.46 |

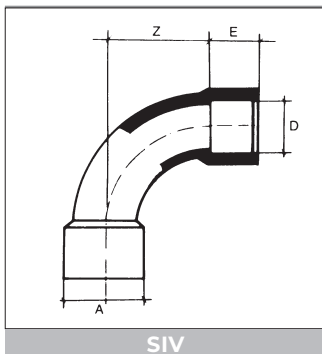

SIV

BOCHTEN 90°
 COURBES A 90°
 BENDS 90°

PN 12.5

Beide zijden lijmmof / Deux côtés femelles à coller / Sockets for solvent welding

| D | DN | Z | E | A | R | €/ST/PC |
|-----|-----|-----|----|-----|-----|---------|
| 50 | 40 | 99 | 31 | 64 | - | 35.59 |
| 63 | 50 | 127 | 38 | 80 | - | 42.26 |
| 75 | 65 | 240 | 62 | 86 | 225 | 109.01 |
| 90 | 80 | 288 | 72 | 103 | 270 | 160.19 |
| 110 | 100 | 352 | 88 | 126 | 330 | 243.92 |

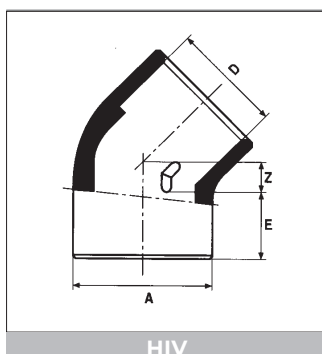

HIV

KNIEEN 45°
 COUDES A 45°
 ELBOWS 45°

PN 12.5

Beide zijden lijmmof / Deux côtés femelles à coller / Sockets for solvent welding

| D | DN | Z | E | A | €/ST/PC |
|-----|-----|------|------|-------|---------|
| 16 | 10 | 4.5 | 14.5 | 21.0 | 1.65 |
| 20 | 15 | 4.5 | 17.0 | 25.5 | 1.76 |
| 25 | 20 | 5.5 | 19.5 | 31.5 | 2.44 |
| 32 | 25 | 8.0 | 23.0 | 39.5 | 3.74 |
| 40 | 32 | 9.5 | 27.0 | 49.0 | 5.81 |
| 50 | 40 | 11.0 | 31.5 | 63.2 | 7.59 |
| 63 | 50 | 14.0 | 38.0 | 72.5 | 11.59 |
| 75 | 65 | 18.0 | 44.0 | 92.0 | 23.15 |
| 90 | 80 | 22.0 | 52.0 | 109.0 | 32.09 |
| 110 | 100 | 24.0 | 62.0 | 131.5 | 48.09 |



lijmfittings
raccords à coller
fittings for solvent welding

VINKAIR

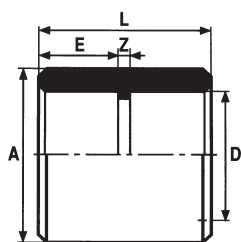

MIV

SOKKEN
MANCHONS
SOCKETS

PN 12.5

Beide zijden lijmmof
Deux côtés femelles à coller
Sockets for solvent welding

| D | DN | Z | E | A | L | €/ST/PC |
|-----|-----|-----|------|-------|-------|---------|
| 16 | 10 | 3.0 | 15.0 | 33.0 | 22.0 | 2.59 |
| 20 | 15 | 3.0 | 17.0 | 26.0 | 37.0 | 2.83 |
| 25 | 20 | 2.5 | 20.0 | 31.5 | 42.5 | 3.32 |
| 32 | 25 | 3.5 | 23.0 | 38.0 | 49.5 | 4.37 |
| 40 | 32 | 4.0 | 26.5 | 48.0 | 57.0 | 6.56 |
| 50 | 40 | 3.0 | 32.0 | 59.5 | 67.0 | 10.41 |
| 63 | 50 | 4.0 | 38.0 | 75.5 | 80.0 | 13.57 |
| 75 | 65 | 4.0 | 45.0 | 91.0 | 94.0 | 31.57 |
| 90 | 80 | 5.0 | 52.0 | 106.5 | 109.0 | 56.75 |
| 110 | 100 | 6.0 | 62.0 | 126.5 | 130.0 | 82.71 |

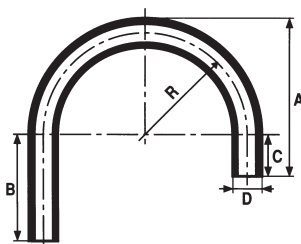

ZIV

U-BOCHTEN 180°
COURBES U A 180°
U BENDS 180°

PN 12.5

Beide zijden lijmuiteinden.
Deux côtés mâles à coller.
Sockets for spigot welding.

| D | DN | R | A | B | C | €/ST/PC |
|----|----|----|-------|-----|----|---------|
| 16 | 10 | 64 | 89.0 | 90 | 17 | 26.42 |
| 20 | 15 | 70 | 100.0 | 90 | 20 | 27.20 |
| 25 | 20 | 75 | 110.5 | 90 | 23 | 27.43 |
| 32 | 25 | 95 | 138.0 | 140 | 27 | 37.61 |

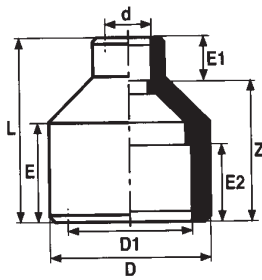

RIV

 VERLOOPSTUKKEN
 REDUCTIONS
 REDUCERS

PN 12.5

 Met in- en uitwendige lijmaansluiting
 A coller sur l'extérieur et à l'intérieur
 Spigot and socket for solvent welding

| D-d | DN | D1 | Z | E | E1 | E2 | L | €/ST/PC |
|---------------|--------|------|------|------|------|------|-------|--------------|
| 25-16 | 20-10 | 16.5 | 25.5 | 19.0 | 14.5 | 14.0 | 40.0 | 4.16 |
| 32-20 | 25-15 | 25.0 | 31.0 | 22.5 | 17.0 | 19.5 | 48.0 | 5.23 |
| 40-25 | 32-20 | 32.0 | 36.5 | 27.0 | 19.5 | 21.5 | 56.0 | 7.17 |
| 50-32 | 40-25 | 40.0 | 45.0 | 32.0 | 23.0 | 27.5 | 68.0 | 8.15 |
| 63-32 | 50-25 | 50.0 | 55.5 | 38.5 | 23.0 | 32.0 | 78.5 | 13.35 |
| 63-40 | 50-32 | 50.0 | 55.5 | 38.5 | 27.0 | 32.0 | 82.5 | 13.35 |
| 75-32 | 65-25 | 61.0 | 62.0 | 45.0 | 22.5 | 38.0 | 85.0 | 38.82 |
| 90-50 | 80-40 | 75.0 | 74.5 | 53.0 | 32.0 | 44.0 | 106.5 | 56.41 |
| 90-63 | 80-50 | 75.0 | 75.0 | 53.0 | 38.5 | 44.5 | 113.5 | 56.41 |
| 110-50 | 100-40 | 90.0 | 90.5 | 62.0 | 32.0 | 52.5 | 122.5 | 84.23 |
| 110-63 | 100-50 | 90.0 | 92.0 | 63.5 | 38.0 | 54.0 | 130.0 | 84.23 |

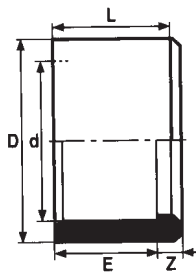

DIV

 VERMINDERINGSRINGEN
 DOUILLES DE REDUCTIONS
 REDUCING BUSHES

PN 12.5

 Met in- en uitwendige lijmaansluiting
 A coller sur l'extérieur et à l'intérieur
 Spigot and socket for solvent welding

| D-d | DN | Z | E | L | €/ST/PC |
|---------------|-----|------|------|------|--------------|
| 20-16 | 15 | 2.5 | 15.0 | 17.5 | 2.30 |
| 25-20 | 20 | 3.5 | 17.0 | 20.5 | 2.30 |
| 32-25 | 25 | 5.0 | 19.5 | 24.5 | 3.32 |
| 40-32 | 32 | 6.0 | 23.0 | 29.0 | 4.29 |
| 50-40 | 40 | 5.0 | 27.0 | 32.0 | 5.65 |
| 63-50 | 50 | 7.0 | 31.5 | 38.5 | 7.95 |
| 75-63 | 65 | 7.5 | 37.0 | 44.5 | 18.33 |
| 90-75 | 80 | 8.0 | 44.0 | 52.0 | 38.57 |
| 110-90 | 100 | 10.5 | 52.0 | 62.5 | 61.33 |



lijmfittings
raccords à coller
fittings for solvent welding

VINKAIR

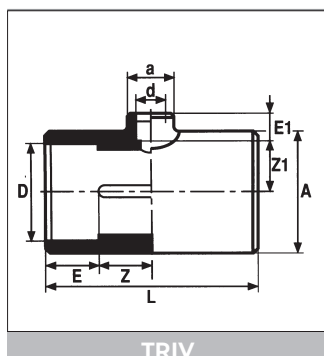

TRIV

VERLOOP T-STUKKEN 90°
TES REDUITS A 90°
REDUCED TEES 90°

PN 12.5

Alle zijden lijmmof
Trois côtés femelles à coller
Sockets for solvent welding

| D-d | DN | Z | Z1 | E | E1 | L | A | a | €/ST/PC |
|-------|-------|------|------|------|------|-------|-------|------|---------|
| 20-16 | 15-10 | 11.0 | 11.0 | 17.0 | 15.0 | 56.0 | 26.0 | 21.0 | 5.42 |
| 25-16 | 20-10 | 14.0 | 14.0 | 18.5 | 14.0 | 66.0 | 31.0 | 21.0 | 6.69 |
| 25-20 | 20-15 | 13.5 | 13.0 | 19.5 | 16.0 | 66.0 | 31.0 | 26.0 | 6.69 |
| 32-16 | 25-10 | 17.0 | 18.0 | 23.0 | 14.0 | 82.5 | 44.5 | 24.0 | 12.37 |
| 32-20 | 25-15 | 17.5 | 18.5 | 23.5 | 16.5 | 82.0 | 39.0 | 26.5 | 12.37 |
| 32-25 | 25-20 | 18.0 | 20.0 | 23.0 | 19.0 | 82.0 | 39.0 | 31.5 | 12.37 |
| 40-20 | 32-15 | 22.0 | 23.0 | 27.0 | 17.0 | 97.5 | 49.5 | 26.5 | 15.93 |
| 40-25 | 32-20 | 22.0 | 23.0 | 27.0 | 19.5 | 97.5 | 49.5 | 31.5 | 15.93 |
| 40-32 | 32-25 | 22.0 | 22.0 | 27.0 | 23.0 | 97.5 | 49.5 | 39.5 | 17.66 |
| 50-25 | 40-20 | 26.5 | 28.0 | 31.0 | 20.0 | 114.5 | 60.5 | 33.0 | 18.70 |
| 50-32 | 40-25 | 26.5 | 28.0 | 31.0 | 23.0 | 115.0 | 61.0 | 41.0 | 18.70 |
| 50-40 | 40-32 | 26.5 | 27.0 | 31.0 | 26.0 | 115.0 | 61.0 | 50.0 | 18.70 |
| 63-25 | 50-20 | 33.5 | 35.0 | 38.5 | 20.0 | 144.0 | 80.0 | 37.0 | 26.93 |
| 63-32 | 50-25 | 33.5 | 35.0 | 38.5 | 23.5 | 144.0 | 80.0 | 45.0 | 26.93 |
| 63-40 | 50-32 | 33.5 | 36.0 | 38.5 | 27.5 | 144.0 | 80.0 | 54.5 | 26.93 |
| 75-25 | 65-20 | 39.0 | 40.0 | 44.5 | 19.5 | 167.0 | 92.5 | 37.0 | 46.72 |
| 75-32 | 65-25 | 38.5 | 38.5 | 44.5 | 23.0 | 166.5 | 92.5 | 45.0 | 46.72 |
| 90-25 | 80-20 | 46.0 | 46.5 | 52.5 | 19.5 | 197.0 | 114.5 | 37.5 | 95.47 |

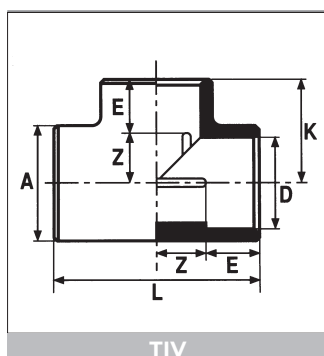

TIV

T-STUKKEN 90°
TES A 90°
TEES 90°

PN 12.5

Alle zijden lijmmof
Trois côtés femelles à coller
Sockets for solvent welding

| D | DN | Z | E | A | L | K | €/ST/PC |
|-----|-----|------|------|-------|-------|-------|---------|
| 16 | 10 | 9.0 | 14.0 | 21.0 | 48.0 | 24.0 | 4.05 |
| 20 | 15 | 11.0 | 17.0 | 26.0 | 56.0 | 28.0 | 3.95 |
| 25 | 20 | 14.0 | 19.0 | 31.5 | 66.5 | 34.0 | 5.81 |
| 32 | 25 | 17.0 | 22.9 | 45.0 | 81.0 | 40.1 | 8.34 |
| 40 | 32 | 22.0 | 27.0 | 49.5 | 97.5 | 50.0 | 13.12 |
| 50 | 40 | 26.5 | 31.0 | 61.0 | 115.0 | 58.0 | 18.59 |
| 63 | 50 | 32.5 | 38.5 | 78.0 | 142.0 | 72.0 | 29.29 |
| 75 | 65 | 39.0 | 44.5 | 91.5 | 166.5 | 83.0 | 62.66 |
| 90 | 80 | 45.0 | 53.0 | 112.0 | 196.5 | 98.0 | 88.52 |
| 110 | 100 | 55.5 | 62.5 | 132.0 | 236.0 | 119.0 | 170.99 |

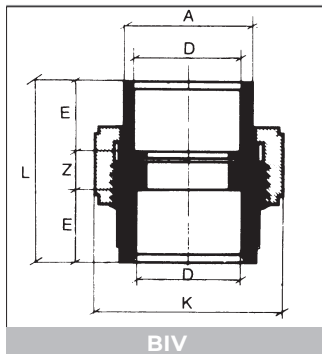

BIV

 DRIEDELIGE KOPPELINGEN
 RACCORDS UNION 3 PIECES
 SOCKET UNIONS 3 PIECES

PN 12.5

 Alle zijden lijmmof, dichting EPDM
 Trois côtés femelles à coller, joint EPDM
 Sockets for solvent welding, seal EPDM

| D | DN | Z | E | A | K | L | €/ST/PC |
|----|----|------|------|------|-------|------|---------|
| 16 | 10 | 14.0 | 15.0 | 22.0 | 34.5 | 44.0 | 14.42 |
| 20 | 15 | 14.0 | 16.5 | 27.5 | 42.5 | 47.0 | 14.42 |
| 25 | 20 | 13.5 | 19.0 | 36.0 | 54.5 | 51.5 | 14.42 |
| 32 | 25 | 14.5 | 22.5 | 41.5 | 62.5 | 59.5 | 16.35 |
| 40 | 32 | 15.0 | 27.0 | 53.0 | 75.5 | 69.0 | 23.60 |
| 50 | 40 | 19.0 | 31.5 | 59.0 | 83.0 | 82.0 | 27.62 |
| 63 | 50 | 22.0 | 38.5 | 74.0 | 100.5 | 99.0 | 36.75 |

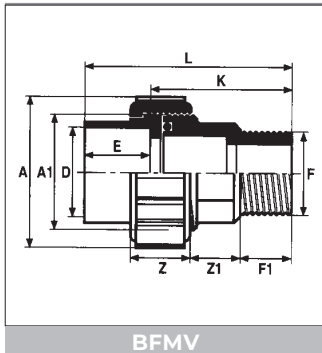

BFMV

 DRIEDELIGE KOPPELINGEN
 RACCORDS UNION 3 PIECES
 SOCKET UNIONS 3 PIECES

PN 12.5

 Eén zijde lijmmof, één zijde buitendraad, dichting EPDM
 Un côté femelle à coller, autre côté filetage male, joint EPDM
 One end socket for solvent welding, other end male tread, seal EPDM

| D x G | DN | Z | Z1 | F1 | L | A | A1 | K | E | €/ST/PC |
|-------------|----|------|------|------|-------|------|--------|------|------|---------|
| 16 x 3/8" | 10 | 19.0 | 11.5 | 11.5 | 52.0 | 36.0 | 3/4" | 36.5 | 15.5 | 16.47 |
| 20 x 1/2" | 15 | 23.0 | 11.0 | 16.5 | 61.0 | 42.0 | 1" | 40.0 | 17.0 | 18.18 |
| 25 x 3/4" | 20 | 25.0 | 17.0 | 18.0 | 72.0 | 55.0 | 1 1/4" | 49.0 | 19.0 | 19.79 |
| 32 x 1" | 25 | 26.0 | 17.5 | 20.5 | 80.5 | 62.5 | 1 1/2" | 53.5 | 23.0 | 25.77 |
| 40 x 1 1/4" | 32 | 30.5 | 17.0 | 23.0 | 88.0 | 73.0 | 2" | 57.5 | 27.0 | 39.50 |
| 50 x 1 1/2" | 40 | 34.0 | 21.0 | 27.0 | 109.0 | 81.5 | 2 1/4" | 62.0 | 32.0 | 39.91 |
| 63 x 2" | 50 | 38.0 | 22.0 | 31.5 | 125.0 | 99.0 | 2 3/4" | 68.0 | 38.0 | 47.83 |

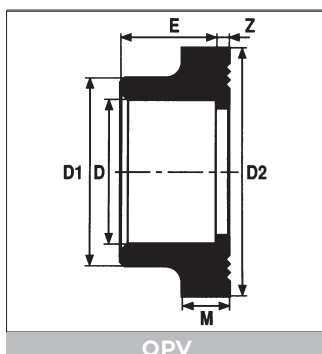

QPV

 GEGROEFDE KRAAGBUSSEN
 COLLETS STRIES
 GROOVED COLLARS

PN 12.5

 Met lijmmof, geleverd zonder dichtingsring
 Un côté femelle à coller, livré sans joint
 Socket for solvent welding, delivered without seal

| D | DN | Z | E | D2 | M | D1 | €/ST/PC |
|-----|-----|---|------|-----|----|-----|---------|
| 50 | 40 | 3 | 32.0 | 73 | 8 | 61 | 15.74 |
| 63 | 50 | 3 | 38.5 | 90 | 9 | 76 | 22.23 |
| 75 | 65 | 3 | 44.0 | 106 | 10 | 90 | 38.38 |
| 90 | 80 | 5 | 52.0 | 125 | 11 | 108 | 54.43 |
| 110 | 100 | 5 | 62.0 | 150 | 12 | 130 | 75.90 |



lijmfittings
raccords à coller
fittings for solvent welding

VINKAIR

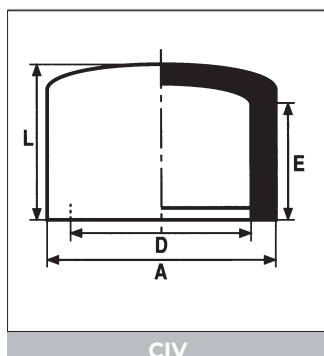

CIV

EINDKAPPEN
BOUCHONS FEMELLES
END CAPS

PN 12.5

Met lijmaansluiting
Côté femelle à coller
Socket for solvent welding

| D | DN | E | L | A | €/ST/PC |
|-----|-----|------|-------|-------|---------|
| 16 | 10 | 14.0 | 20.0 | 24.0 | 2.30 |
| 20 | 15 | 17.5 | 22.0 | 26.0 | 2.69 |
| 25 | 20 | 19.5 | 25.5 | 31.5 | 3.05 |
| 32 | 25 | 24.0 | 30.0 | 39.5 | 4.05 |
| 40 | 32 | 28.0 | 36.5 | 48.0 | 6.43 |
| 50 | 40 | 33.0 | 43.0 | 59.5 | 8.06 |
| 63 | 50 | 40.5 | 52.5 | 75.0 | 11.03 |
| 75 | 65 | 52.0 | 77.0 | 91.0 | 27.43 |
| 90 | 80 | 59.0 | 91.5 | 107.5 | 38.38 |
| 110 | 100 | 66.0 | 109.5 | 129.0 | 65.47 |

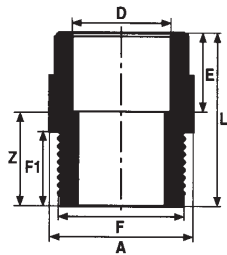

KIFV - Type A

 OVERGANGSSTUKKEN
 EMBOUTS D'ADAPTATION
 ADAPTOR COUPLINGS

PN 12.5

Eén zijde cilindrische buitendraad, andere zijde inwendige lijmaansluiting.
 Un côté mâle à filetage cylindrique, l'autre à coller comme femelle.
 One end male parallel threaded, the other end socket for solvent welding.

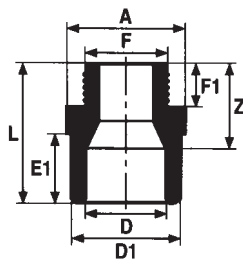

KIFV - Type B

| D x G | D1 | Z | E | A | L | F1 | E1 | TYPE | €/ST/PC |
|-------------|----|------|------|------|------|------|------|------|---------|
| 16 x 1/2" | | 27.5 | 15.0 | 24.5 | 42.5 | 15.0 | | A | 4.71 |
| 16 x 3/8" | 20 | 24.5 | 15.0 | 25.0 | 39.5 | 12.0 | 17.0 | B | 11.59 |
| 20 x 1/2 | 25 | 29.0 | 17.0 | 30.0 | 46.0 | 15.0 | 19.0 | B | 13.62 |
| 20 x 3/4" | | 31.5 | 17.0 | 30.0 | 48.5 | 17.0 | | A | 5.54 |
| 25 x 3/4" | 32 | 33.5 | 19.5 | 36.5 | 53.0 | 17.0 | 23.0 | B | 15.93 |
| 25 x 1" | | 35.0 | 21.0 | 36.5 | 56.0 | 19.5 | | A | 5.65 |
| 32 x 1" | 40 | 43.5 | 22.5 | 47.0 | 66.0 | 20.0 | 27.0 | B | 20.77 |
| 32 x 1 1/4" | | 40.0 | 23.0 | 47.0 | 63.0 | 21.5 | | A | 9.15 |
| 40 x 1 1/4" | 50 | 45.0 | 26.5 | 55.0 | 71.5 | 21.5 | 32.0 | B | 37.32 |
| 40 x 1 1/2" | | 42.5 | 27.0 | 48.0 | 69.5 | 22.5 | | A | 17.11 |
| 50 x 1 1/2" | 63 | 46.0 | 31.5 | 68.0 | 77.5 | 23.0 | 38.5 | B | 49.46 |
| 50 x 2" | | 49.5 | 32.5 | 60.0 | 82.0 | 27.0 | | A | 24.37 |
| 63 x 2" | 75 | 49.0 | 38.5 | 78.5 | 87.5 | 27.5 | 44.0 | B | 65.20 |
| 75 x 2 1/2" | 90 | 49.5 | 45.0 | 94.0 | 94.5 | 30.5 | 51.8 | B | 79.66 |

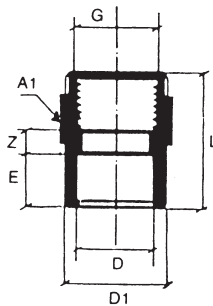

DIMV

 OVERGANGSSTUKKEN
 EMBOUTS D'ADAPTATION
 ADAPTOR COUPLINGS

PN 12.5

Eén zijde lijmof of spie, de andere inwendige draad met (BSP) met metalen versterkingsring.
 Un côté à coller, l'autre côté taraudage pas gaz cylindrique avec bague métallique de renforcement.
 One end for solvent welding, the other end female threaded (BSP) with metal reinforcing ring.

| D' x D x G | DN | Z | E | L | A' | €/ST/PC |
|------------------|----|----|------|----|----|---------|
| 20 x 16 x 3/8" | 10 | 5 | 14.0 | 31 | 23 | 11.59 |
| 25 x 20 x 1/2" | 15 | 5 | 16.0 | 38 | 27 | 13.62 |
| 32 x 25 x 3/4" | 20 | 5 | 19.0 | 42 | 34 | 15.93 |
| 40 x 32 x 1" | 25 | 5 | 22.0 | 48 | 41 | 20.77 |
| 50 x 40 x 1 1/4" | 32 | 11 | 27.5 | 58 | 55 | 37.32 |
| 63 x 50 x 1 1/2" | 40 | 19 | 31.0 | 64 | 65 | 49.46 |
| 75 x 63 x 2" | 50 | 19 | 32.0 | 85 | 70 | 65.20 |

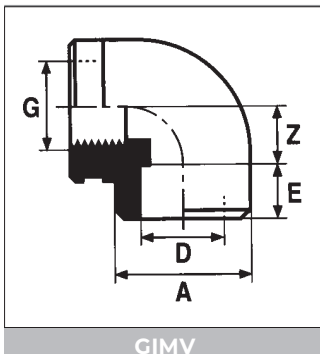

GIMV

KNIEEN 90°
 COUDES A 90°
 ELBOWS 90°

PN 12.5

Eén zijde lijmof, andere zijde inwendige draad (BSP) met metalen versterkingsring.
 Un côté femelle à coller, l'autre côté taraudé pas gaz cylindrique avec bague métallique de renforcement.

One socket end for solvent welding, the other end female threaded (BSP) with metal reinforcing ring.

| D x G | DN | Z | E | A | €/ST/PC |
|-----------|----|----|------|----|---------|
| 16 x 3/8" | 10 | 9 | 15.0 | 24 | 14.42 |
| 20 x 1/2" | 15 | 11 | 17.0 | 29 | 14.42 |
| 25 x 3/4" | 20 | 14 | 19.5 | 36 | 15.45 |

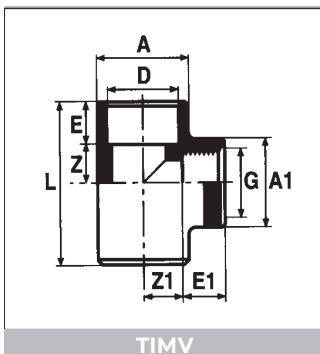

TIMV

T-STUKKEN 90°
 TES A 90°
 TEES 90°

PN 12.5

Twee zijden lijmof, de spruit met inwendige draad (BSP) met metalen versterkingsring.
 Deux côtés femelles à coller, tubelure taraudé pas gaz cylindrique avec bague métallique de renforcement.

Two socket ends for solvent welding, female threaded (BSP) branch with metal reinforcing ring.

| D x G | DN | Z | E | L | Z1 | E1 | A | A1 | €/ST/PC |
|-----------|----|----|----|------|------|----|------|----|---------|
| 16 x 1/2" | 10 | 9 | 15 | 48.0 | 12.0 | 17 | 25.0 | 35 | 12.95 |
| 20 x 1/2" | 15 | 14 | 17 | 61.5 | 14.5 | 17 | 30.5 | 30 | 12.95 |
| 25 x 3/4" | 20 | 13 | 20 | 66.5 | 15.5 | 20 | 35.0 | 40 | 17.00 |



overgangsfittings vzw messing inzetstuk
raccords d'adaptation à insert laiton
adaptor couplings with brass insert

VINKAIR

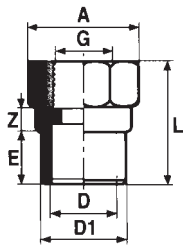

DIMM

OVERGANGSMOF BINNENDRAAD
MANCHON D'ADAPTATION FIL.FEMELLE
ADAPTOR SOCKET FEMALE THREADED

Eén zijde inwendige draad messing, andere zijde lijmmof
Un côté taraudage pas gaz cylindrique en laiton, l'autre côté à coller.
One side female brass thread, other side for solvent welding.

| D x G | DN | Z | E | L | D1 | A | €/ST/PC |
|-------------|----|-----|------|------|----|------|---------|
| 16 x 3/8" | 10 | 9.0 | 17.0 | 38.5 | 20 | 32.2 | 11.59 |
| 20 x 1/2" | 15 | 9.0 | 16.5 | 44.0 | 25 | 36.0 | 13.62 |
| 25 x 3/4" | 20 | 9.5 | 19.5 | 49.0 | 32 | 41.4 | 15.93 |
| 32 x 1" | 25 | 9.8 | 23.0 | 56.4 | 40 | 49.6 | 20.77 |
| 40 x 1 1/4" | 32 | 7.0 | 31.0 | 64.0 | 50 | 60.0 | 37.32 |
| 50 x 1 1/2" | 40 | 7.0 | 37.5 | 69.5 | 63 | 66.0 | 49.46 |
| 63 x 2" | 50 | 8.0 | 43.5 | 80.5 | 75 | 82.0 | 65.20 |

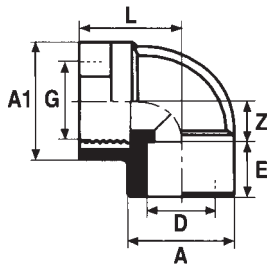

GIMM

OVERGANGSKNIE 90° BINNENDRAAD
COUDE D'ADAPTATION 90° FIL.FEMELLE
ADAPTOR ELBOW 90° FEMALE THREADED

Eén zijde inwendige draad messing, andere zijde lijmmof
Un côté taraudage pas gaz cylindrique en laiton, l'autre côté à coller.
One side female brass thread, other side for solvent welding.

| D x G | DN | Z | E | A | A1 | L | €/ST/PC |
|-----------|----|----|------|----|----|------|---------|
| 20 x 1/2" | 15 | 16 | 16.5 | 29 | 36 | 32.0 | 15.08 |

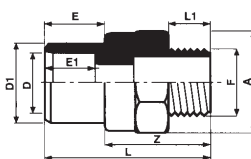

KIMM

OVERGANGSNIPPEL BUITENDRAAD
EMBOUTS D'ADAPTATION FIL.MALE
ADAPTOR NIPPLE MALE THREADED

Eén zijde uitwendige draad messing, andere zijde lijmmof
Un côté mâle taraudage pas gaz cylindrique en laiton, l'autre côté à coller.
One side male brass thread, other side for solvent welding.

| D x D' x G | Z | E | E1 | A | L | L1 | €/ST/PC |
|------------------|------|------|------|------|-------|------|---------|
| 16 x 20 x 3/8" | 32.5 | 17.0 | 15.0 | 32.2 | 49.5 | 11.0 | 11.59 |
| 16 x 20 x 1/2" | 36.5 | 16.5 | 14.5 | 32.2 | 53.5 | 13.5 | 13.62 |
| 20 x 25 x 1/2" | 41.0 | 19.0 | 17.0 | 36.0 | 60.0 | 15.0 | 15.93 |
| 25 x 32 x 3/4" | 43.0 | 22.5 | 19.5 | 41.0 | 65.0 | 16.0 | 20.77 |
| 25 x 32 x 1" | 45.5 | 23.0 | 19.0 | 49.5 | 68.5 | 19.5 | 20.77 |
| 32 x 40 x 1" | 49.0 | 27.0 | 23.0 | 49.5 | 76.0 | 19.5 | 20.77 |
| 40 x 50 x 1 1/4" | 55.0 | 31.0 | 26.0 | 60.0 | 87.0 | 22.0 | 37.32 |
| 50 x 63 x 1 1/2" | 55.0 | 37.5 | 31.0 | 66.0 | 92.0 | 22.0 | 49.46 |
| 63 x 75 x 2" | 63.0 | 43.5 | 37.5 | 82.0 | 106.0 | 26.0 | 65.20 |

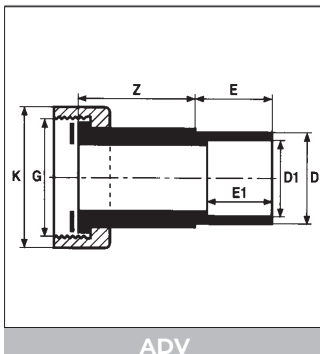
 OVERGANGSSTUKKEN
 DOUILLES DE RACCORDEMENT
 TAP CONNECTORS

PN 12.5

Overgangskoppeling met messing moer. Dichting EPDM
 Raccords d'adaptation avec écrou en laiton. Joint: EPDM
 Adaptor coupling with brass nut. Seal: EPDM

| D x G | DN | Z | E | D1 | E1 | K | €/ST/PC |
|-------------|----|----|----|----|------|------|---------|
| 16 x 1/2" | 10 | 20 | 15 | 12 | 14,0 | 24,0 | 13.99 |
| 20 x 3/4" | 15 | 22 | 17 | 16 | 15,0 | 29,5 | 16.35 |
| 25 x 1" | 20 | 23 | 20 | 20 | 17,0 | 36,0 | 21.25 |
| 32 x 1 1/4" | 25 | 26 | 23 | 25 | 19,5 | 45,0 | 27.33 |
| 40 x 1 1/2" | 32 | 29 | 27 | 32 | 23,0 | 52,0 | 41.80 |

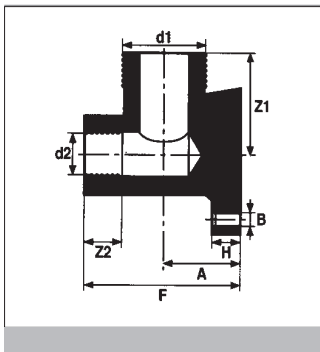
 MUURPLATEN (MESSING)
 APPLIQUES MURALES (LAITON)
 WALL BRACKETS (BRASS)

Minimale hoeveelheid: 10 stuks
 Quantité minimale: 10 pièces
 Minimum quantity: 10 pieces

| d1 - d2 | DN | A | B | Z1 | Z2 | C | D | E | F | €/ST/PC |
|-------------|----|------|---|------|------|---|----|----|------|---------|
| 1/2" - 3/8" | 10 | 17.0 | 5 | 36.0 | 7.5 | 6 | 18 | 17 | 35.5 | 31.28 |
| 3/4" - 1/2" | 15 | 18.5 | 5 | 38.0 | 10.0 | 6 | 20 | 19 | 42.5 | 40.80 |
| 1" - 3/4" | 20 | 24.5 | 5 | 39.5 | 12.0 | 8 | 26 | 24 | 52.5 | 39.53 |

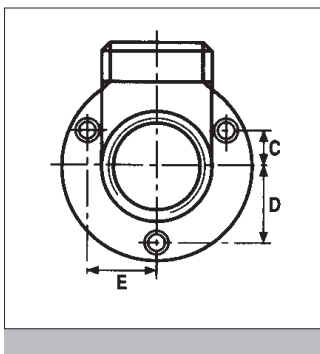



kranen
vannes
valves

VINKAIR

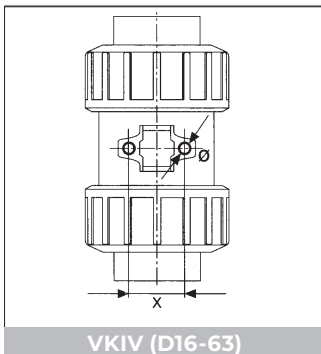

VKIV (D16-63)

KOGELKRANEN
VANNES A BILLE
BALL VALVES

Maximale gebruikstemperatuur: 50°C.
Maximale werkdruk: 12.5 bar.
Twee zijden lijmmof.

Température maximale d'utilisation: 50°C.
Pression de service maximale: 12.5 bar.
Deux côtés femelle à coller.

Maximum working temperature: 50°C.
Maximum working pressure: 12.5 bar
Sockets for solvent welding.



VKIV (D75-110)

| d | L | Z | E | H | D | A | a | J | €/ST/PC |
|-----|-----|-----|----|-----|-----|-----|----|-----|---------|
| 16 | 97 | 67 | 14 | 45 | 47 | 66 | 14 | 29 | 51.44 |
| 20 | 102 | 68 | 16 | 45 | 47 | 66 | 14 | 29 | 52.33 |
| 25 | 120 | 82 | 19 | 55 | 57 | 78 | 14 | 33 | 57.54 |
| 32 | 131 | 87 | 22 | 67 | 68 | 86 | 18 | 38 | 77.57 |
| 40 | 150 | 98 | 26 | 83 | 86 | 100 | 19 | 45 | 93.65 |
| 50 | 163 | 101 | 31 | 91 | 98 | 110 | 20 | 53 | 130.15 |
| 63 | 197 | 121 | 38 | 111 | 122 | 130 | 23 | 63 | 161.31 |
| 75 | 234 | 211 | 43 | 177 | 211 | - | 25 | 105 | 379.97 |
| 90 | 252 | 211 | 52 | 177 | 211 | - | 25 | 105 | 379.97 |
| 110 | 300 | 252 | 63 | 220 | 252 | - | 30 | 121 | 504.79 |

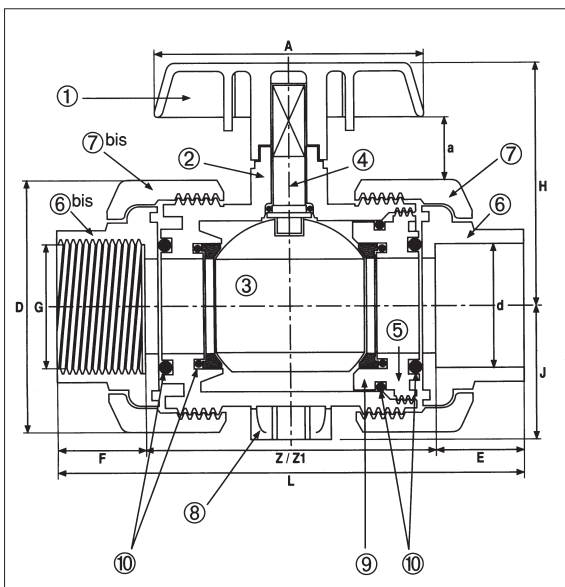

Materiaal:

- 1: handvat / poignée / ball seat: PVC-U
- 2: lichaam / corps / housing: VINKAIR
- 3: kogel / bille / ball: VINKAIR
- 4: as / axe / spindle: VINKAIR
- 5: dichtingszitting / porte-joints / gasket seat: VINKAIR
- 6: aansluitstukken / collets / collars: VINKAIR
- 7: wartelmoeren / écrous / union nuts: VINKAIR
- 8: montagevoet: inwendige draad. / supportmontage: fixation intégrée en laiton / anchoring: brass insert
- 9: dichtingsring / joint / gasket: EPDM
- 10: kogelzittingen / siège / ball seat: PTFE